

Vision

Upright display cabinet with static refrigeration (RS) with partial double glazing and insulated door. Monolithic structure with 60 mm thick ecological polyurethane insulation (HCFC and HFC free) with CO₂. Interior and exterior in white plastic sheet metal. Door aluminum frame painted grey color and self-closing facility with seal return hinges. Large door handle for easy grip. Fluorescent lighting positioned vertically. Carbon powder-coated steel frame with rollers for easy handling and two adjustable feet to stabilize the cabinet. Control panel with electronic control. Automatic self-evaporating condensate drip tray. Hermetic condensing unit. Adjustable side shelf supports. Illuminated back-lit panel above the door.



ENERGY SAVING
LED + EC Fan motor



INSTALLATION
Plug-in



TEMPERATURE
RS TB: -18 °C
RV TB: -18/-16 °C



DEFROST
Manual



CLIMATIC CLASS
7

Standard equipment

	Q.ty - Q.tà	Mod.
Grid with supports (390x495)	5	DV 350
Grid bottom (385x435)	1	ST- DV 350
Grid with supports (540x495)	5	DV 500
Grid bottom (535x435)	1	ST- DV 500



Vision Technical features

		350	500
External dimensions (LxDxH)		520 x 740 x 1935 mm	670 x 740 x 1935 mm
Capacity (gross/net)		353 / 296 lt	485 / 385 lt
		353 / 230 lt	485 / 315 lt
Net weight		108 kg	128 kg
Refrigeration		Static - Ventilated - R290	
Refrigerant Refrigerante			
Climatic class Classe climatica		7	
Operating conditions Condizioni ambientali		35 °C / 75% RH	
Product temperature Temperatura prodotto	RS TB	-18 °C	
	RV TB	-18/ -16 °C	
Compressor (q.ty-type) Compressore (q.tà-tipologia)		1 Hermetic - 1 Ermetico	
Defrost Sbrinamento	RS TB	Manual - Manuale	
	RV TB	Hot gas - Gas caldo	
Power supply Alimentazione		230 V / 1 Ph / 50 Hz	
Electrical input (standard) Assorbimento elettrico (standard)	RS TB	700 W / 4 A	850 W / 4,7 A
	RV TB	750 W / 3,8 A	950 W / 5,3 A
Electrical input (defrost) Assorbimento elettrico (sbrinamento)	RS TB	-	-
	RV TB	1060 W / 4,9 A	1080 W / 5,8 A

Vision Section

ST

350

500

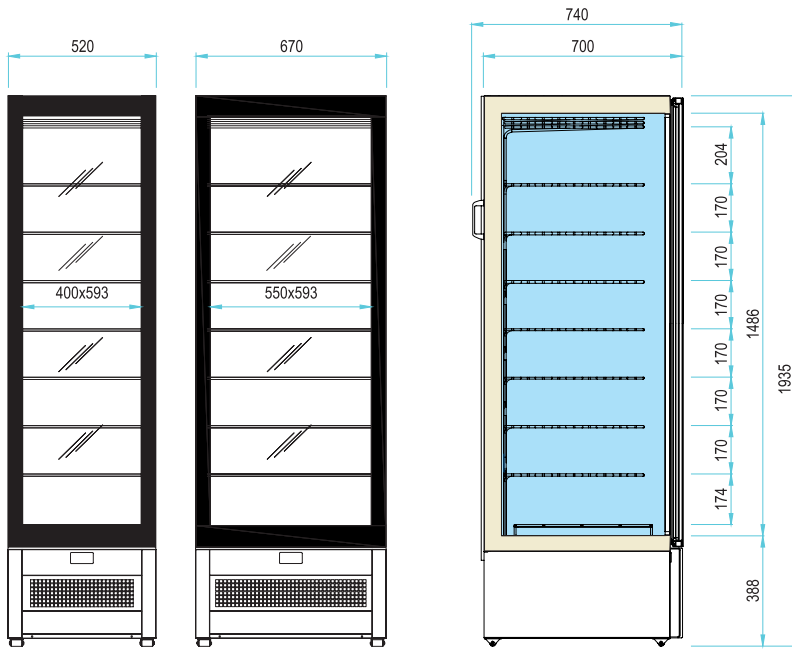

DISPLAY

	350	500
Grid dimensions [LxD] Dimensioni griglie [LxPx]	390 x 495 mm	540 x 495 mm
Grid bottom dimensions [LxD] Dimensioni griglia fondovasca [LxPx]	385 x 435 mm	535 x 435 mm

Vision Section

RV

340

470

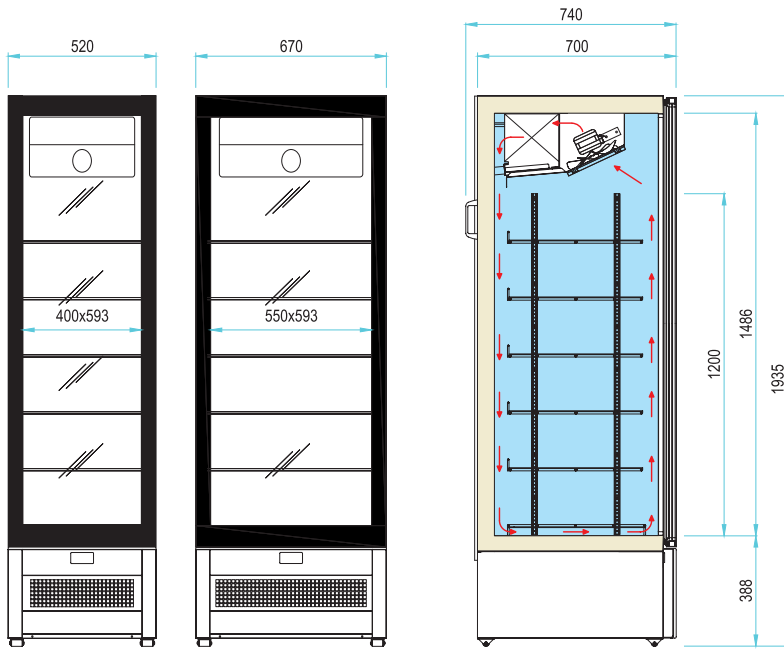

	350	500
Grid dimensions [LxD]	380 x 470 mm	530 x 470 mm
Grid bottom dimensions [LxD]	385 x 435 mm	535 x 435 mm

Vision Optionals

Item
Grid with supports [380x470]
Grid bottom [385x435]
Grid with supports [530x470]
Grid bottom [535x435]

